

# SCHEDULE 1

## DUNHELEN STAGE 1 BUILDING ENVELOPES

M.G.A. 2020 | ZONE 55

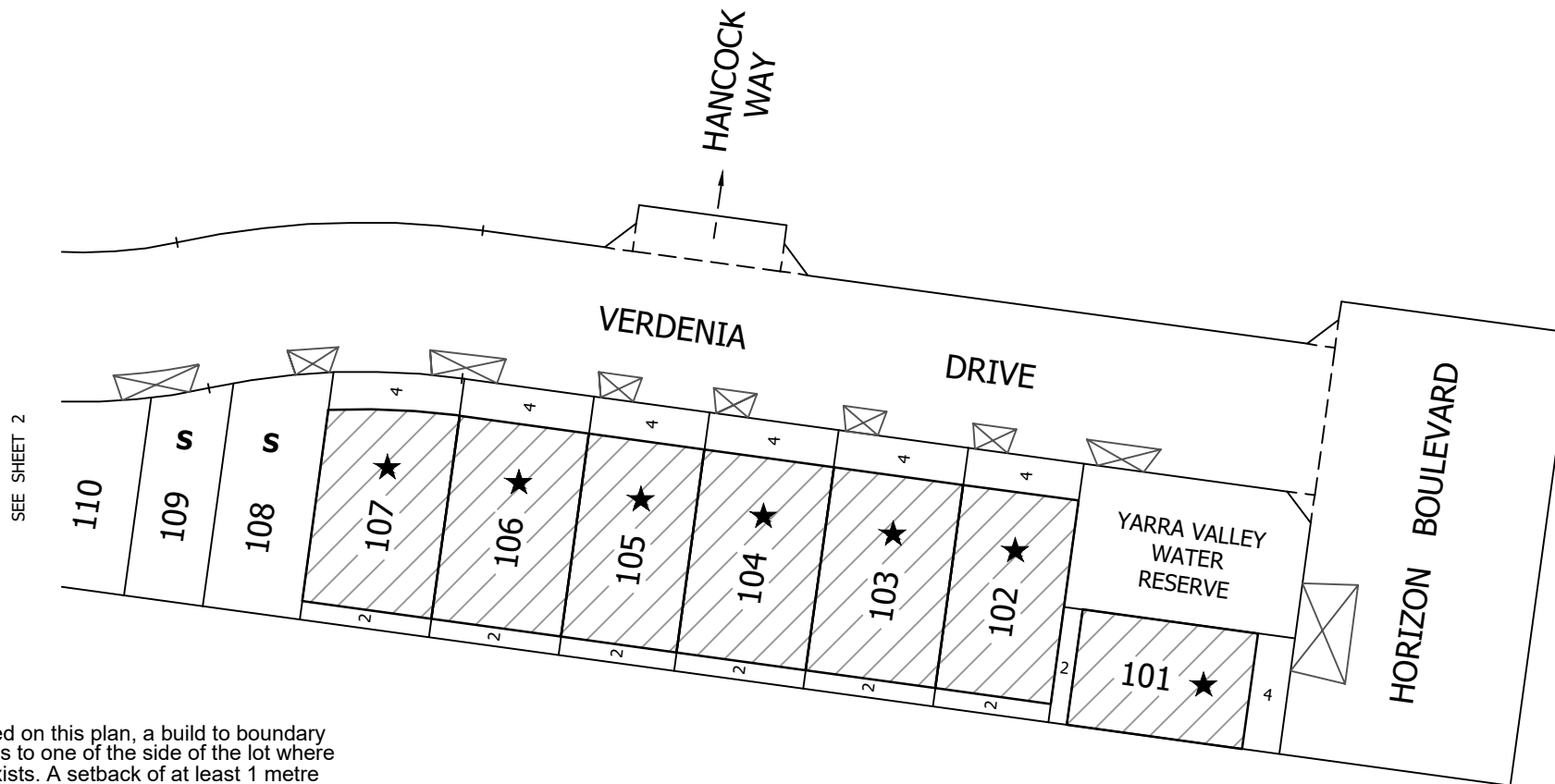

**NOTES:**

★ Unless nominated on this plan, a build to boundary zone only applies to one of the side of the lot where the crossover exists. A setback of at least 1 metre must be provided for the opposite side boundary.

⊗ Indicative crossover location

**S** Small Lot Housing Code

Garages are to be set back a minimum of 5.5 metres from the primary frontage of the allotment and 0.50 metres behind the front of the dwelling

80285BE-018B.DWG



MC MULLEN NOLAN GROUP  
Level 1 / 5 Queens Road  
Melbourne VIC 3204  
Tel: (03) 7002 2200  
Fax: (08) 7002 2299  
Email: vic.admin@mngsurvey.com.au

SCALE  
1:750

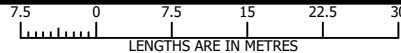

ORIGINAL SHEET  
SIZE A4

SHEET 1 OF 2

VERSION B



# SCHEDULE 1

## DUNHELEN STAGE 1 BUILDING ENVELOPES

M.G.A. 2020 | ZONE 55

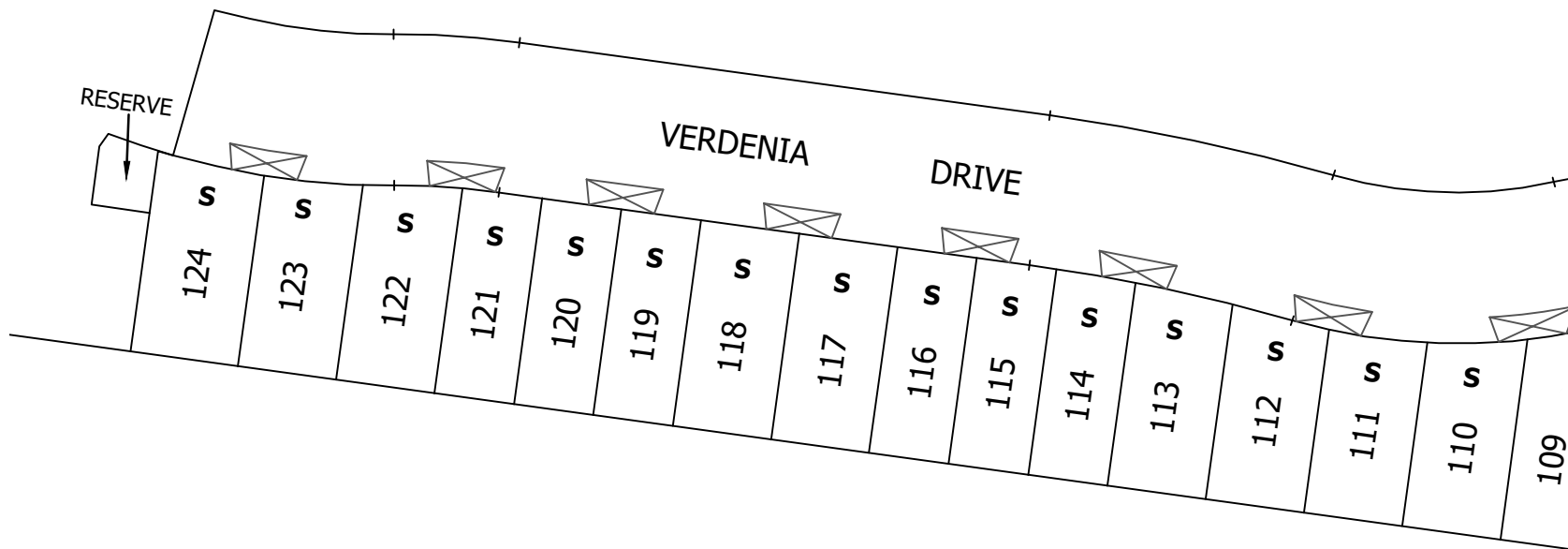

SEE SHEET 1

**NOTES:**

★ Unless nominated on this plan, a build to boundary zone only applies to one of the side of the lot where the crossover exists. A setback of at least 1 metre must be provided for the opposite side boundary.

Indicative crossover location

**S** Small Lot Housing Code

Garages are to be set back a minimum of 5.5 metres from the primary frontage of the allotment and 0.50 metres behind the front of the dwelling

80285BE-018B.DWG

MC MULLEN NOLAN GROUP  
Level 1 / 5 Queens Road  
Melbourne VIC 3204  
Tel: (03) 7002 2200  
Fax: (08) 7002 2299  
Email: vic.admin@mngsurvey.com.au

SCALE 1:750

LENGTHS ARE IN METRES

ORIGINAL SHEET SIZE A4 SHEET 2 OF 2

VERSION B

